

# AFO(M)4000

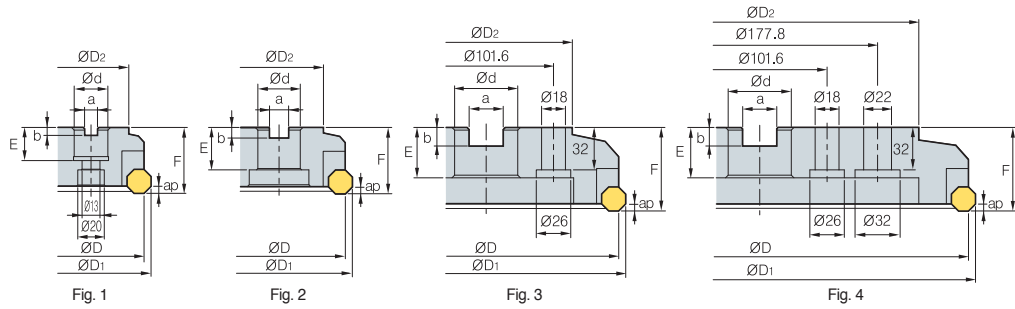

(mm)

Designation		ØD	ØD1	ØD2	Ød	a	b	E	F	ap		Fig.
<b>AFO</b> 4080R/L	5	80	88	60	25.4 (27)	9.5 (12.4)	6 (7)	25 (22)	50	3.3	1.4	1
<b>(AFOM)</b> 4100R/L	6	100	108	80	31.75 (32)	12.7 (14.4)	8 (8)	32 (28)	50	3.3	2.0	1
4125R/L	8	125	133	100	38.1 (40)	15.9 (16.4)	10 (9)	38 (30)	63	3.3	3.1	1

( ) Metric size

## Available inserts

	OFCW	OFKT-MF	OFKT-MM	OFKT-MA			
Designation	Cermet	Coated				Uncoated	page
	CN2000 CN30	NCM325 NC5330 NCM535 NCM545	PC2010 PC3600 PC3700 PC6510 PC9530 PC9540 PC5300 PC5400	ST30A G10 H01			
OFCW 05T3SN						E13	
05T3FN							
05T308FN							
OFKT 05T3SN-MF			●			E13	
05T308SN-MF							
05T3SN-MM		●		●		E14	
05T308SN-MM							
05T3FN-MA					●		
05T3EN-MA							

## Available arbors

Designation	General arbor	NC arbors	
		AFO	AFOM
<b>AFO</b> 4080R/L	NT*□□ (M/U)-FMA25.4-25	BT**□□ -FMA25.4-□□	FMC27
<b>(AFOM)</b> 4100R/L	NT*□□ (M/U)-FMA31.75-□□	BT**□□ -FMA31.75-□□	FMC32
4125R/L	NT*□□ (M/U)-FMA38.1-□□	BT**□□ -FMA38.1-□□	FMB40

\*□□-NT number \*\*□□-BT number \*\*\*Over milling 5

## Recommended cutting condition

Workpiece	Cutting condition		Grades
	vc (m/min)	fz (mm/t)	
<b>P</b>	190~320	0.05~0.20	<b>NCM325</b> <b>PC3500</b> <b>ST30A</b>
	161~270	0.05~0.20	
	80~140	0.05~0.20	
<b>M</b>	90~150	0.05~0.20	<b>PC9530</b>
<b>K</b>	140~230	0.05~0.30	<b>PC6510</b> <b>G10</b>
	50~90	0.05~0.30	

## Assembling

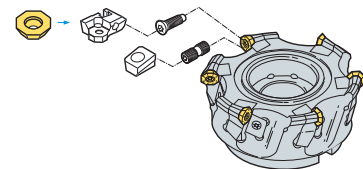

## Parts

Specification					
Ø80~Ø125	LAF04R/L	WAF04R/L	DHA0815	FTKA0408	TW15S

Available inserts E13, E14

Available arbors and bolt E400~E402